

1"

IF THIS BAR DOES NOT MEASURE EXACTLY ONE INCH, THE SCALE OF THIS DRAWING HAS BEEN ALTERED DURING ITS PRODUCTION, AFFECTING ALL LABELED SCALES

W:\Projects\1014.23010-MCS\_GardenCity\1014.23010-Mobile - Scans\Sheet\Fem: PLAN Jul 01, 2024 12:00 PM

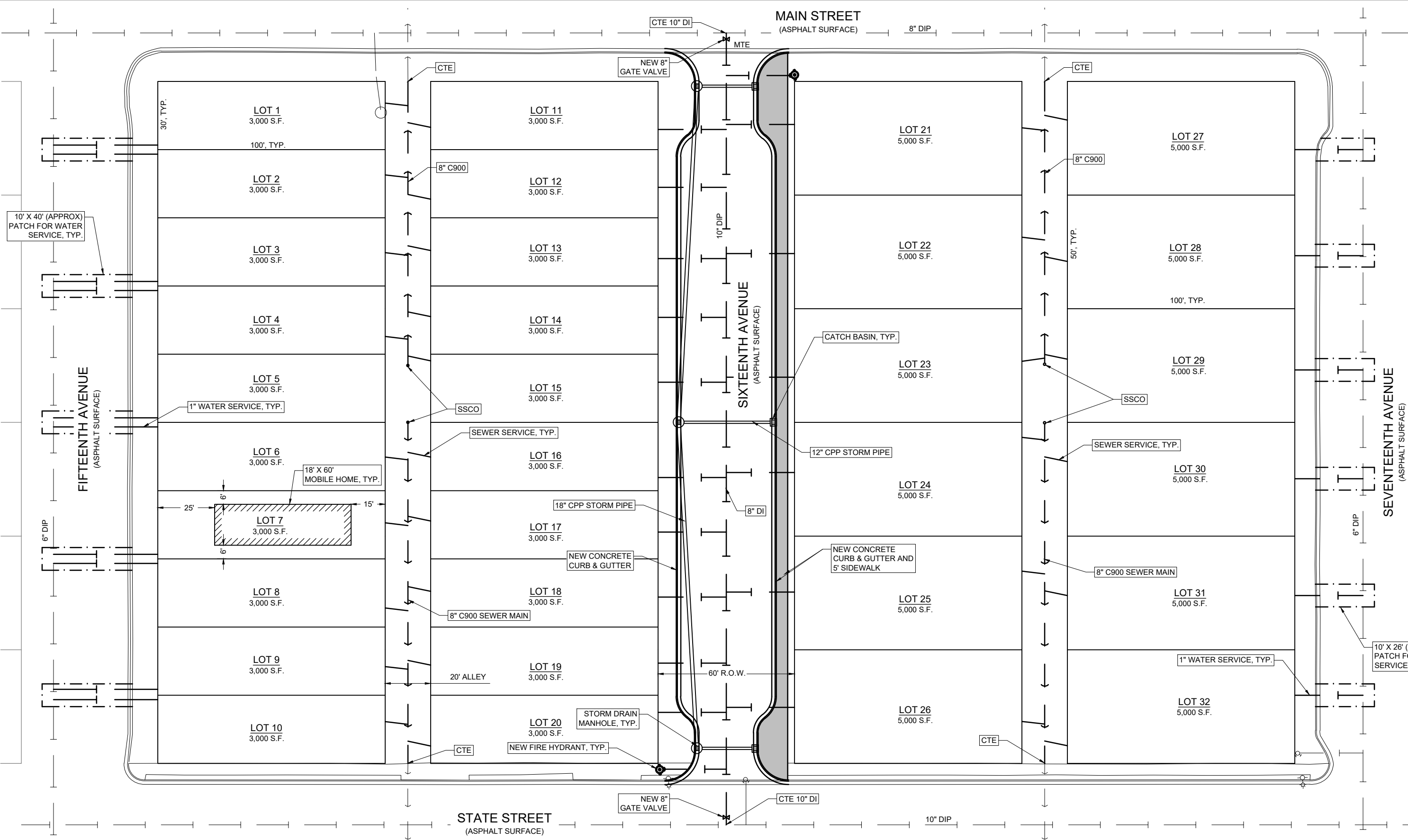

**NOTES:**  
 1. SEE 16TH AVENUE ROADWAY TYPICAL SECTION FOR DETAILS.

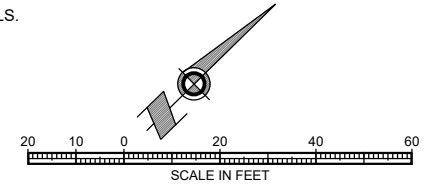

No.	Date	Item
REVISIONS		

**SHEET TITLE :**  
 20 LOT MOBILE HOME LAYOUT &  
 12 LOT RESIDENTIAL LAYOUT  
**CONCEPTUAL LAYOUT**

**PROJECT :**  
 MUNICIPALITY OF SKAGWAY  
 GARDEN CITY R/V PARK  
 CONCEPTUAL LAYOUT  
 SKAGWAY, ALASKA

**RESPEC**  
 Juneau, AK  
 9109 Mendenhall Mall Rd. Ste. 4  
 Juneau, AK 99801  
 Phone: 907.780.6060  
 Fax: 907.586.3771  
 AECC163270



**CLIENT :**  
 MUNICIPALITY OF SKAGWAY  
 GARDEN CITY R/V PARK

DESIGN	JMP
DRAWN	JMK
CHECKED	JMP
DATE	07/01/2024
PROJECT No. <b>11014.23010</b>	
SHEET NUMBER <b>1 of 1</b>	